

Exclusive Charter

PREMIER
WORLD DISCOVERY



Personal Touch Tours presents

Normandy, Paris & the Seine River Cruise

featuring 7 nights aboard the Amadeus Diamond

9 Days **October 20 - October 28, 2020**

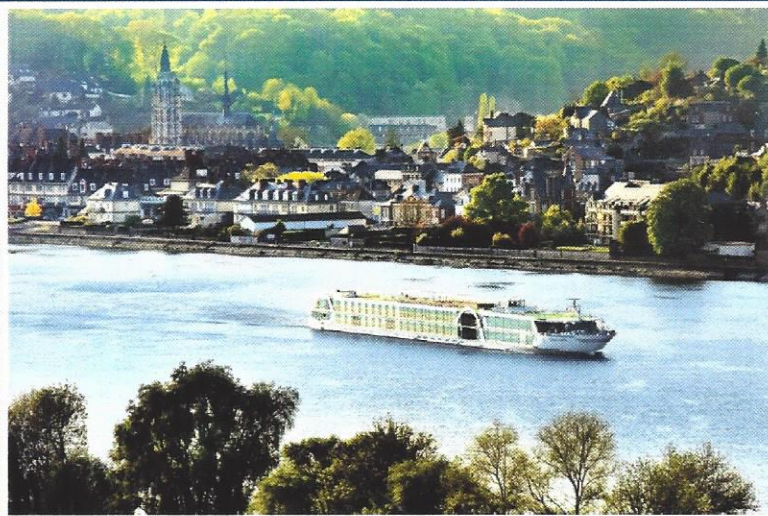

Booking Discount - Save \$200 per couple!

Daily Itinerary

Cities & Ports



Normandy, Paris & the Seine River Cruise

9 Days October 20 - October 28, 2020

Ship - Diamond

Day 1 Depart US - Overnight Flight

Day 2 Arrive Paris

Meet your PWD Tour/Cruise Manager - Transfer to your ship
Board the **MS Amadeus Diamond** for your **7 Night Seine River Cruise**

Welcome Drink & Welcome Dinner Onboard

Meals - D Overnight - Amadeus Diamond

Day 3 Conflans

Morning Cruising - Arrive in **Conflans**

Afternoon **Auvers-sur-Oise Tour & Auberge Ravoux Visit** (Van Gogh home)

Meals - B,L,S & D Overnight - Amadeus Diamond

Day 4 Rouen

Morning - **Rouen Walking Tour** (Museum Town)

Afternoon **Optional Excursion along the Abbey Trail**

Meals - B,L,S & D Overnight - Amadeus Diamond

Day 5 Le Havre

Morning - **Étretat Tour** (Walk along the Normandy Coastline & scenic village)

Afternoon at Leisure or **Optional Excursion to Honfleur**

Meals - B,L,S & D Overnight - Amadeus Diamond

Day 6 Le Havre - Caudebec-en-Caux

Full Day Tour of Historic Normandy with Lunch (WWII D-Day Landing Beaches)

Meals - B,L,S & D Overnight - Amadeus Diamond

Day 7 Les Andelys

Leisure Day - **Morning Optional Excursion to Chateau Gaillard & Giverny**

Afternoon Seine River Cruising & Relax Onboard

Gala Farewell Dinner Onboard

Meals - B,L,S & D Overnight - Amadeus Diamond

Day 8 Paris

Morning - **Paris City Tour**

Afternoon at Leisure in Paris to explore on your own OR

Optional Excursions - Montmartre Walking Tour OR Palace of Versailles

Final Dinner Onboard

Meals - B,L,S & D Overnight - Amadeus Diamond

Day 9 Paris - Flight Home

Transfer to the Paris Airport for your flight home

Meal - B

B - Breakfast • L - Lunch • D - Dinner Onboard w/ Regional Wines
S - Snacks Onboard afternoon and/or evening

Optional 2-Night London Post Cruise Extension

\$895 pp dbl +\$400 single supplement

Day 9/Oct 28 Paris - Eurostar Train - London Sightseeing

Board the **Eurostar Train** in Paris for the 2.5 hour rail experience to London.
Upon arrival enjoy a panoramic **London City Tour** to see Kensington Palace, the Tower of London, Trafalgar Square, the Houses of Parliament, Big Ben & Buckingham Palace.

Meal - B (onboard ship)

Overnight - London

Day 10/Oct 29 London - Day at Leisure

Enjoy a day of leisure to explore London on your own. Maybe shop at famous Harrods, visit a museum, enjoy the theatre or take in a meal at a local pub. An optional excursion will be available featuring Windsor Castle.

Meal - B

Overnight - London

Day 11/Oct 30 London - Transfer to Airport - Flights Home

Meal - B

London Optional Extension Includes: 2-Nights Hotel Accommodations - London, Eurostar Train from Paris to London, London City Tour, 2 Meals (2-Breakfasts), Tour Manager & Transfers to London Heathrow Airport.

Notes: London Extension must be booked at time of deposit. Due to group air policies outbound air on 10/20/2020 could be different schedule than the rest of group for London extension passengers. Based on 20 passenger minimum.

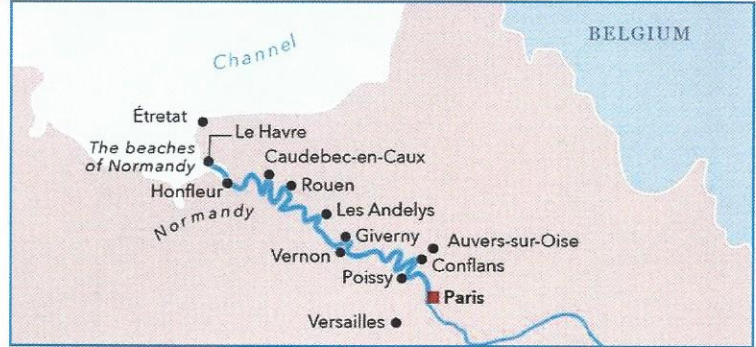

Paris

Paris, the "City of Light" is the world's most visited capital. Enjoy a **Paris City Tour** to see the beloved landmarks that line the Seine including the Notre Dame Cathedral, the Louvre and the Eiffel Tower. Also see the majestic Arc de Triomphe and ride along the Champs-Élysées. During your leisure afternoon wander the historic banks of the Seine which are a UNESCO World Heritage Site, or maybe join an optional excursion to the Palace of Versailles or Montmartre.

Conflans - Auvers-sur-Oise - Auberge Ravoux

Conflans is only an hour or so from Paris but things move much slower in this town. Visit the little town of **Auvers-sur-Oise**, an inspiration to many of the famous Impressionist masters including Cezanne, Pissarro and Daubigny. The most famous of these artists is Vincent van Gogh, whose final resting place is located here. Visit **Auberge Ravoux**, where Van Gogh lived in a very simple and small room only lit by sky light. Inspired by the picturesque site with its inhabitants and surroundings, Van Gogh painted close to 80 canvases here.

Rouen

Enjoy a **Rouen Walking Tour** including a visit to the magnificent cathedral that inspired Claude Monet, and the modern Church of Joan of Arc with its magnificent 16th-century stained-glass windows. Rouen is known as Museum Town for its many museums, was important in the Roman era and Middle Ages, and features a cobbled pedestrian center with medieval half-timbered houses.

Le Havre - Etretat

A UNESCO World Heritage Site & important port, **Le Havre**, sits where the Seine River meets the English Channel. The harbor was destroyed in World War II and was rebuilt. Enjoy a **Etretat Tour** to explore the famous Normandy coastline featuring cliff-top paths for views of steep chalk rocks with impressive needle-like formations, which have inspired many well-known artists. Enjoy some leisure time during the tour in the attractive village of Etretat as well.

Historic Normandy Tour

Discover Normandy on this full day tour featuring many historic landmarks. See **Arromanches**, the closest harbor linked with the liberation of Western Europe after D-Day. The staggeringly big concrete blocks remain from the Mulberry artificial harbor of the massive Allied operations. Visit Longues-sur-mer with its artillery battery and the only German coastal defense battery classified as an historic monument on the **D-Day Landing Beaches**. Enjoy lunch in **Bayeux** to see the famous Cathedral & fabulous historic center. Later visit Calvados and experience a brandy tasting at a traditional distillery.

Les Andelys

This morning your vessel anchors in the quaint little town of Les Andelys in the shadow of Chateau Gaillard, the one time home to Richard the Lionheart. After a long day to Normandy, today is the perfect day to relax onboard & enjoy the amenities of your ship & passing Seine scenery. An optional is available to visit Chateau Gaillard and nearby Giverny, home to Impressionist Claude Monet.



Ship & Onboard Experience

The Ship - MS Amadeus Diamond

The 144-passenger MS Amadeus Diamond has been a highlight of the fleet since 2009, and will be the new jewel of the French waterways after its complete renovation for 2019. The refresh will upgrade both the interior of the ship and the ship's technology. The Diamond travels exclusively along the Seine and allows guests to experience the charm of northern France in an unforgettable way. The extensive Restaurant and the Panorama Bar offer divine views of the passing riverscapes. The 60-staterooms & 12-suites are bright, modern and provide a wonderful private space to enjoy your river cruise. The attentive English Speaking onboard service staff will see to your comfort with typical European hospitality. The beauty of river cruising is that the most interesting destinations come to you. This Diamond charter features English-only onboard commentary with inclusive sightseeing excursions balanced with choice to simply relax onboard during your leisure time or add sightseeing with optional excursions. The ship offers countless choices for your leisure time including a putting green, fitness studio, massage facilities & quiet spaces to escape with a book.

All Meals Included Onboard

Three meals daily are served graciously in the single seating designed exquisite restaurant and feature local & international specialties. All dinners are four courses and are served with included Regional Wines. While dining, you have splendid views of the passing scenic landscapes through large picture windows. Enjoy afternoon and/or late evening snacks in the lounge based on the daily schedule.

Comfortable, Well-appointed Staterooms

After boarding, unpack only once. All staterooms onboard offer excellent river views and are bright, modern and inviting giving you a space of your own with all the amenities and pleasant touches of an upscale hotel. The Mozart & Strauss Decks feature suites and staterooms with French Balconies. Staterooms on the Haydn Deck have a fixed window. Each stateroom is fully equipped with comfortable & modern furnishings including flat screen TV, individual heating/air conditioning controls, safe, phone, hair dryer and a private bathroom with shower.



Staterooms & Suites



Stateroom (162 sq ft)

Staterooms feature 2 twin beds that can be separated or put together, flat screen TV, hair dryer, private bath with shower, closet, phone, desk, chair & safe. Floor to ceiling sliding glass doors with French Balcony on Mozart & Strauss Decks. Fixed window on Haydn Deck.

(cabin size and amenities can vary, French Balcony features floor to ceiling sliding doors, not a walk-out balcony)



Suite (237 sq ft)

Suites are on the Mozart Deck & feature floor to ceiling sliding glass doors with French Balcony, 2 twin beds that can be separated or put together, flat screen TV, hair dryer, private bath with shower & bathtub, phone, closet, desk, chair, safe & mini bar.

(Suite size and amenities can vary, French Balcony features floor to ceiling sliding doors, not a walk-out balcony)

Inclusions & Highlights

- Roundtrip Airfare - JFK
- 7 Night Cruise - Outside Cabin
- 22 Meals (9-B, 6-L, 7-D)
- PWD Tour/Cruise Manager
- Regional Wine with Dinners
- Welcome & Farewell Dinners
- English Speaking Ship Staff
- Baggage Handling
- Int'l Air Taxes/Fuel/Fees & Port Charges
- Hotel & Ship Transfers
- Non-smoking environment (Sun Deck exception)
- Onboard Entertainment - Music & Lectures

Included Excursions/Tours & Highlights

- Paris City Tour
- Historic Normandy Tour - WWII D-Day Landing Beaches
- Arromanches & Bayeux Visits
- Calvados Brandy Tasting
- Auvers-sur-Oise Tour
- Auberge Ravoux Visit - Van Gogh home
- Rouen Walking Tour
- Étretat Tour - Normandy Coast & Village
- Stops in Conflans, LeHavre & Les Andelys

Optional Excursions

Abbey Trail, Honfleur, Giverney & Chateau Gaillard, Montmartre Walking Tour, and Palace of Versailles

Rates

Category E/Haydn Deck	\$4,765 pp/dbl
Category D/Haydn Deck	\$5,065 pp/dbl
Category C/Strauss Deck	\$5,565 pp/dbl
Category B/Strauss Deck	\$5,765 pp/dbl
Category A/Mozart Deck	\$5,965 pp/dbl
Suite/Mozart Deck	\$6,365 pp/dbl
Single Supplements	
Cat E&D	+\$1,200
Cat C&B	+\$1,500
Cat A	+\$1,800
Suite	+\$2,200

Booking Discount - \$200 per couple/\$100 per person
(see back for details)

Rouen



Le Havre



Les Andelys

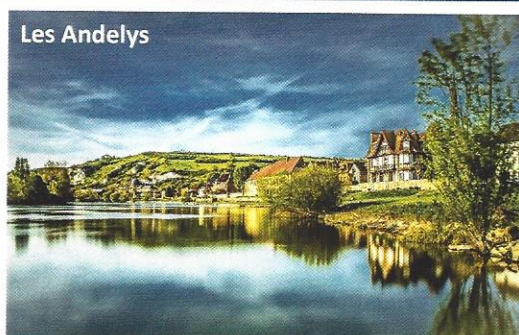

MS Amadeus Diamond Deck Plan

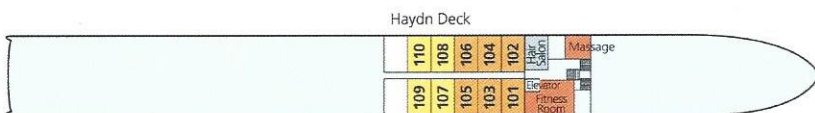
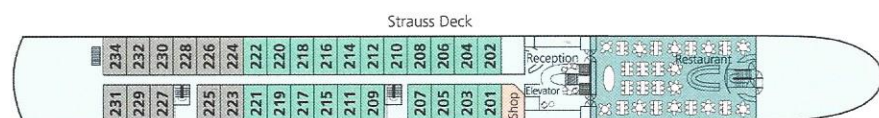
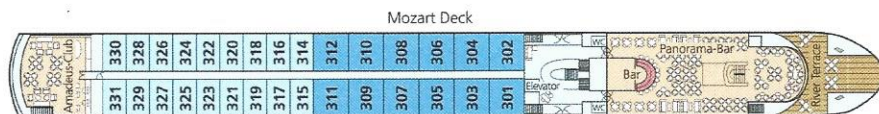
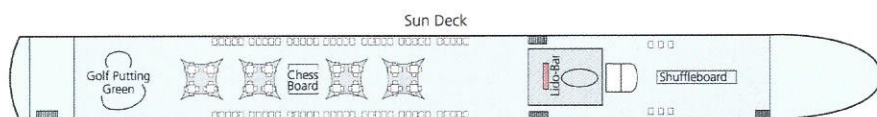
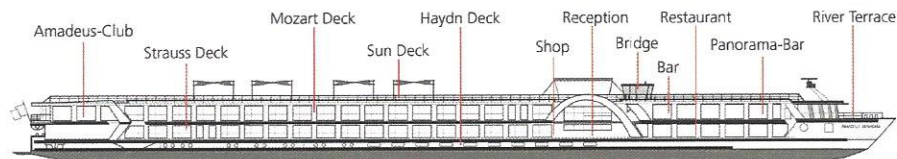

- Suite - Mozart Deck
- Category A - Mozart Deck
- Category B - Strauss Deck
- Category C - Strauss Deck
- Category D - Haydn Deck
- Category E - Haydn Deck

CHOOSE YOUR CABIN			
Deck	Category	Size	Window
Mozart-Deck	12 Amadeus-Suites	237 sf	Glass doors (French Balcony)
Mozart-Deck	18 Cabins	162 sf	Glass doors (French Balcony)
Strauss-Deck	32 Cabins	162 sf	Glass doors (French Balcony)
Haydn-Deck	10 Cabins	162 sf	Window

Standard Cabin (162 sq ft)

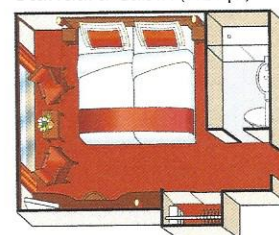

Suite (237 sq ft)

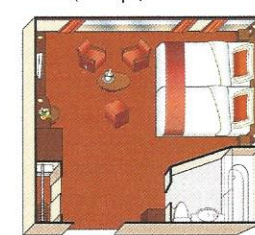

TECHNICAL DATA:

Refurbished:	2019	Decks:	4
Built in:	2009	Registry:	Germany
Length:	361 ft	Crew members:	40
Width:	36.5 ft	Cabins/Suites:	60/12

Reservation Information

DEPOSIT & FINAL PAYMENT - A deposit of \$500 per person is due with reservation form to secure reservations. Final payment is due by July 20, 2020.

BOOKING DISCOUNT - Deposit by March 20, 2020 and make your Final Payment by check prior to July 20, 2020 & receive a \$100 per person Booking Discount. Final payment must be by check. Initial Deposit can be made by check or credit card to be eligible. Payments after the Initial Deposit are considered part of the Final Payment & must be made by check. Bookings after 3/20/20 are not eligible for Bkg Discount.

CRUISE/SHIP NOTES - Cabin categories are limited & booked on a first come, first served basis. Cruise line reserves the right to change the itinerary & make some ship modifications. Port Charges/Taxes are included in cruise rates (\$185) and are subject to change until Final Payment.

ONLINE BOOKING OPTION - Save time, postage & secure your seat for this group departure. Simply type <https://res.premierworlddiscovery.com> into your web browser & use the Booking Number (Web Code) from this flyer to make your Deposit online in just a few minutes. No need to submit a Reservation Form if booking online.

PREMIER'S TRAVEL PROTECTION PLAN (TPP) - \$425 per person

The Pre-Departure Cancellation Fee Waiver (Part A - I & II) is provided by Premier World Discovery (PWD) and is not an insurance benefit. The Post-Departure Travel Insurance Plan (Part B) is provided by USI Affinity Travel Insurance Services (USI).

Part A - Cancellation Waiver provided by PWD

I. Trip Cancellation Waiver (TCW) - Guarantees full refund on all payments, except the TPP Fee itself in case of cancellation up to the time and date of departure due to the passenger's personal illness or death of a member of the immediate family; or, if the passenger must return early due to the passenger's personal illness or death of a member of the immediate family, a refund for the unused land services. Medical/official documentation required.

II. Premier "Any Reason" Cancellation Waiver (ARCW) - Reimburses 75% of the cancellation fees in the form of a future travel credit certificate (FTCC) valid for 1 year, if you cancel more than 48 hours prior to scheduled departure for any reason not eligible for cash refund under the TCW (Part A - I.). FTCC is non-transferable, may not be redeemed for cash and does not include any credit for the TPP Fee. The TPP Fee (if chosen) is refundable until 180 days prior to departure & cannot be added after Final Payment.

The TPP does not cover any single supplement charges due to an individual's traveling companion cancelling prior to departure. The TPP is non-transferable and valid for each applicant only. The TPP does not cover any services such as airline tickets not purchased through PWD. Cancellations, Claims & Inquiries under Part A will be administered by PWD. Certain Exclusions and Restrictions apply.

Part B - Post-Departure Travel Insurance Plan provided by USI

Includes coverage for: Trip Interruption (\$1,000); Trip Delay (\$100/Day-Max \$500); Baggage & Personal Effects (\$2,000); Baggage Delay (\$500); Emergency Accident/Sickness Medical Expense (\$30,000); Emergency Evacuation/Repatriation (\$150,000); Accidental Death & Dismemberment (\$25,000); Emergency Travel Assistance (24/7). Claims & Inquiries under Part B will be administered by USI.

For full Part A and Part B policy details visit: premierworlddiscovery.com/TPP

CANCELLATION FEES

Cancellations are subject to the following per person fees (see below for Suites);

- Cancel on or prior to March 20, 2020: \$200 pp is retained*
- Cancel March 21, 2020 - 90 days prior to departure: Deposit or TPP** is retained
- Cancel 89-60 days prior to departure: 35% of total price
- Cancel 59-30 days prior to departure: 50% of total price
- Cancel 29 days or less prior to departure/no shows: No refunds

*Suite Deposits are Non-Refundable. **If TPP purchased with Deposit.

PASSPORT INFORMATION

A valid US passport is required for this tour and is the responsibility of each passenger. Passports must be valid for up to six (6) months beyond the travel dates. All names must be submitted to Premier exactly as they appear on passenger passports.

RESPONSIBILITY

Premier World Tours LLC dba Premier World Discovery (hereafter PWD), whose vouchers are used by respective agents for the passenger in all matters pertaining to hotel accommodations, cruise ship, sightseeing tours and transportation, hold themselves free of responsibility for any damages occasioned from any cause whatsoever. PWD will not be responsible for any damages or inconvenience caused by late arrivals, departures and change of schedule or other conditions nor will they be responsible for any act, omission, or event during the time the passenger is not on board their conveyance. The passage contract in use by the airline concerned, when issued, shall constitute the sole contract between the airline and the purchaser of this tour/cruise, and/or passenger. PWD does not hold any responsibility for the conduct of any of its members, hotel, motorcoach, cruise line, train, airline or other personnel. PWD reserves the right to decline to accept or retain any person as a member of a tour/cruise at its discretion. PWD &/or its Tour Director retain the right to require any participant to withdraw from a tour/cruise at any time, if determined to be in the best interests of health, safety & general welfare of the tour/cruise group or of the individual participant. Arbitration - I/We agree, any and all disputes concerning this contract or any other material concerning the trip, or the trip itself must be resolved exclusively pursuant to binding arbitration in the state of California, pursuant to the then current rules of the American Arbitration Association. Payment of the deposit for this tour/cruise constitutes acceptance of these terms and conditions. Itinerary and hotels are subject to change. CST #2048841-40

IMPORTANT CONDITIONS/NOTES

Cruisetour rates are subject to increase until you are paid in full.

London Extension Air Note - Due to group air policies outbound air on the DEPARTURE DATE could be different than the rest of the group for the London Extension passengers.